

# Terwin TEBP Series Extrusion Burst Plugs

Information is deemed correct at time of issue and is subject to change without prior notice

Standard Burst Pressures Are As Follows:-

- 3M5 - 3,500psi
- 5M5 = 5,500psi
- 7M5 = 7,500psi
- 9M5 = 9,500psi

Other burst pressures are available to special order.

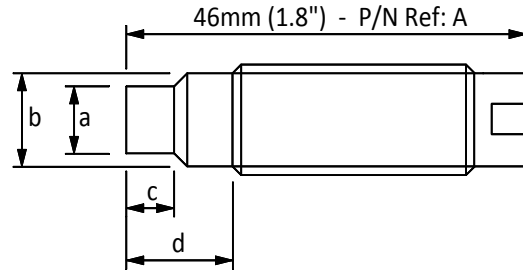
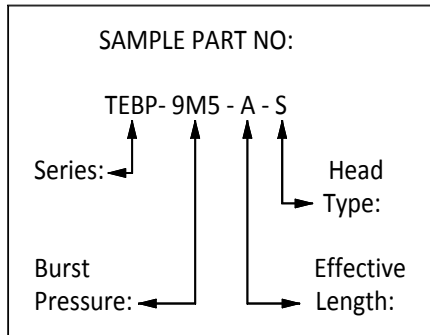

- a = 7.77±0.03 (0.306±0.001)
- b = 10.49±0.03 (0.413±0.001)
- c = 5.54±0.12 (0.218±0.005)
- d = 12.2 (0.48)

Standard Thread Size = 1/2"-20UNF

Other thread sizes are available to special order

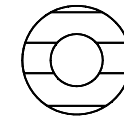

Screwdriver Slot:  
P/N ref = S

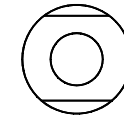
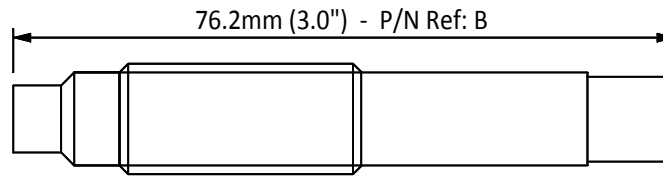

Pair Of Flats:  
P/N ref = F

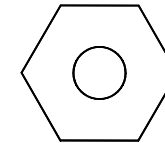
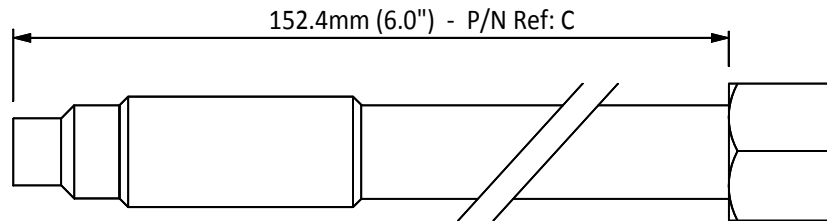

5/8 Hex:  
P/N ref = H



**Terwin Instruments Limited**

Winterbeck Industrial Estate  
Orston Lane  
BOTTFESFORD,  
Nottinghamshire.  
NG13 0AU  
Tel: +44 (0) 1949 84 2000  
Fax: +44 (0) 1949 84 2004

DRAWN	GAW	DRG. NO.
DATE	16.05.2007	MCD/2000/0274
CHECKED	T.W	TITLE
APPROVED	T.W	TERWIN TEBP SERIES EXTRUSION BURST PLUGS

CAD REF.	MATERIAL:
TI274.FCW	Body: 17-4 Stainless Steel. Disc: 316L Stainless Steel
<b>TOLERANCES U.O.S.:</b> .xxxx ±0.005, .xxx ±0.05, .xx ±0.01 ANGLES ±0.5° CONCENTRICITY: ALL DIA'S WITHIN 0.05 T.I.R.	

A	16.05.2007	IST ISSUE	G.W.
ISS	DATE	DESCRIPTION	APP'D