

© TERWIN INSTRUMENTS LIMITED OWN THE COPYRIGHT OF THIS DRAWING WHICH IS NOT TO BE COPIED, REPRODUCED OR DISCLOSED TO A THIRD PARTY WITHOUT WRITTEN PERMISSION

IF IN DOUBT ASK DO NOT SCALE



ALL DIMENSIONS IN MMS

U.S.O.

SCALE N.T.S

THIS IS A C.A.D. DRAWING DO NOT ALTER MANUALLY

Terwin P/N: 210-4002

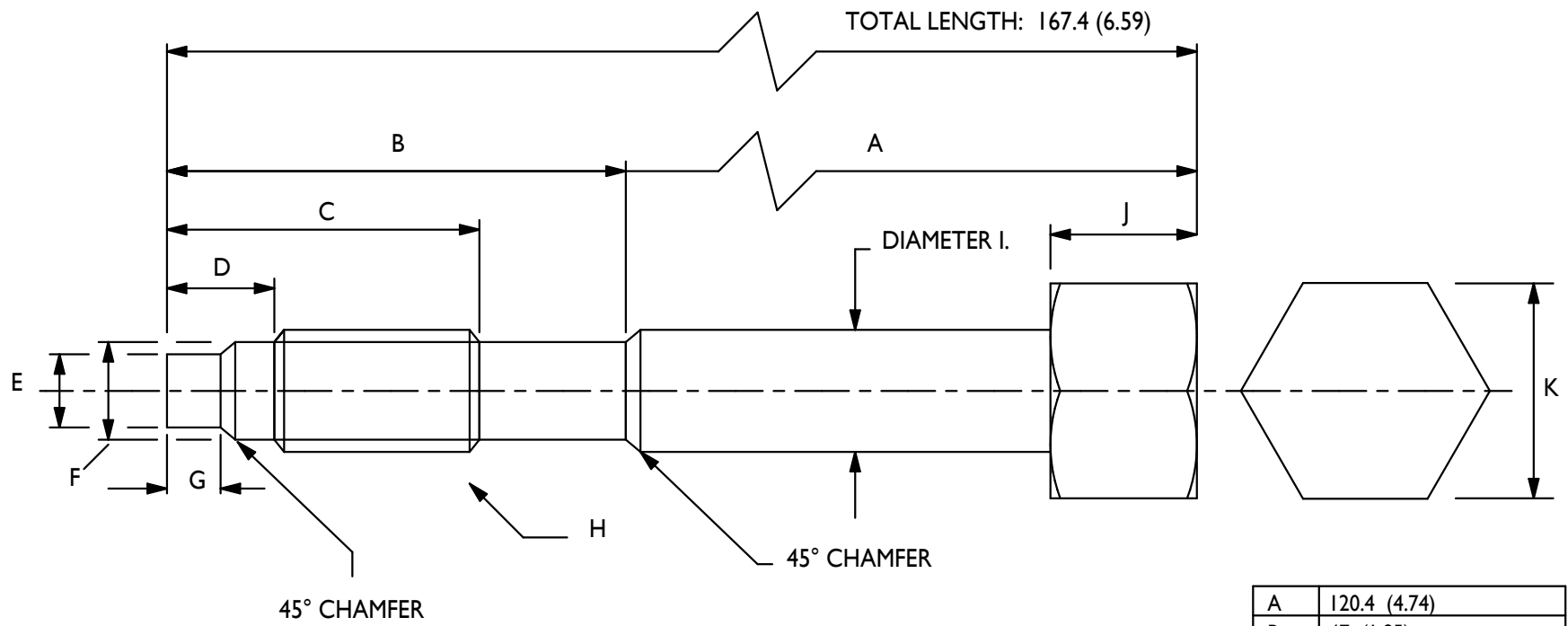

A	120.4 (4.74)
B	47 (1.85)
C	31.3 (1.23)
D	12.2 (0.48)
E	7.77±0.03 (0.306±0.001)
F	10.49±0.03 (0.413±0.001)
G	5.54±0.12 (0.218±0.005)
H	1/2-20-UNF-2A
I	12.7 (0.50)
J	15.0 (0.59)
K	22 A/F (0.866)

NOTE: Must be one piece construction.



Terwin Instruments Limited

Winterbeck Industrial Estate,
Orston Lane
BOTTESFORD
Nottinghamshire
NG13 0AU
Tel: +44 (0) 1949 84 2000
Fax: +44 (0) 1949 82 2004

DRAWN	GAW
DATE	20.4.2011
CHECKED	T.W.
APPROVED	G.W.

DRG. NO.	MPD/2000/0303
TITLE	Terwin 6" Blanking Bolt

CAD REF.	TI303
MATERIAL:	303 Stainless Steel
TOLERANCES U.O.S: xxxx ±0.005, xxx ±0.05, xx ±0.01 ANGLES ±0.5° CONCENTRICITY: ALL DIA'S WITHIN 0.05 T.I.R.	

A	20.4.2011	IST ISSUE	G.W.
ISS	DATE	DESCRIPTION	APPD